



**North Sound Youth Symphony
Member Handbook
2024–2025 Season**

Table of Contents	
NSYS General Information	1
Rehearsals	2
Concerts	5
Support NSYS	6
Code of Conduct*	8

*Please sign and return at your next rehearsal.

NSYS General Information

We grow musicians!

North Sound Youth Symphony (NSYS) was established in 1993 to provide an opportunity for band and orchestra students ages 9 to 22 years old to unite in a symphony orchestra with strings, woodwinds, brass, and percussion. In cooperation with the Western Washington University (WWU) Department of Music, we draw on the expertise of the University's staff and students to provide the best possible musical experience and education for young musicians, complementing and supporting the musical offerings in public schools. NSYS has two performance levels: Symphony, conducted by Professor Grant Donnellan, for advanced students, and Philharmonia, conducted by Rebekah Hood-Sava, for younger students.

Our goals:

- To strive for musical excellence through the performance and in-depth study of repertoire of the highest educational and artistic quality
- To give young musicians the opportunity to reach their maximum potential
- To offer a fun, memorable, and inspirational musical experience
- To provide a symphony orchestra opportunity for all aspiring young musicians, regardless of gender, race, physical ability, or economic status
- To encourage students to develop self-esteem, leadership, responsibility, commitment, cooperation, and discipline
- To support our community through free public concerts presenting the timeless beauty of classical music

Board of Directors

As a non-profit 501(c)(3) organization, NSYS is governed by a Non-Profit Board of Directors. The Board consists of parents of current NSYS students, parents of NSYS alumni, and community members. NSYS relies on parent volunteers to operate and to create an enjoyable and productive atmosphere for students.

2024–2025 Board of Directors

Co-Presidents: Julie Dugger, Kim Markworth

Vice President: Peyton Winterowd-Laughman

Treasurer: Robin Elwood

Secretary: Rachel Throolin

Communications & Publicity: Thai Blair

Past President: Kate Destler

Members-at-Large: Bryce Fegley, Lisa Humphrey, Cris Manterola, Judy Widrig

To contact the NSYS Board, email president@northsoundyouthsymphony.org.

Rehearsals

Day, Time, and Location

Rehearsals are held Monday evenings from 6:30 to 8:30 PM. Students are expected to be “ready to play” at 6:30 PM, so they should arrive 10–15 minutes early to sign in, find their rooms, set up their chairs and stands, and assemble their instruments.

Rehearsals are held at the Performing Arts Center (PAC) at WWU. Check-in is just outside the elevator on Lower Level 2.

Rehearsal Rooms

Students begin their rehearsals either working as a full ensemble or in sectionals. Information about where students report first will be available at check-in. Although subject to change, the NSYS room schedule is available here:

- [Fall 2024 Room Schedule](#)
- [Winter 2025 Room Schedule](#)
- [Spring 2025 Room Schedule](#)

Depending on space availability, full-ensemble rehearsals are held in the Concert Hall (room 155), the Band Room (room 24), or the Choir Room (room 16). Sectionals are held in rooms 24, 16, 27, 47, 123, 168, or the Choir Library (located near the Choir Room). See the map below or the map on our website (<https://www.northsoundyouthsymphony.org/parent-resource/>) for help with finding these locations. Rehearsal volunteers will be on hand to assist students. The PAC can be confusing, but students quickly learn to navigate it!

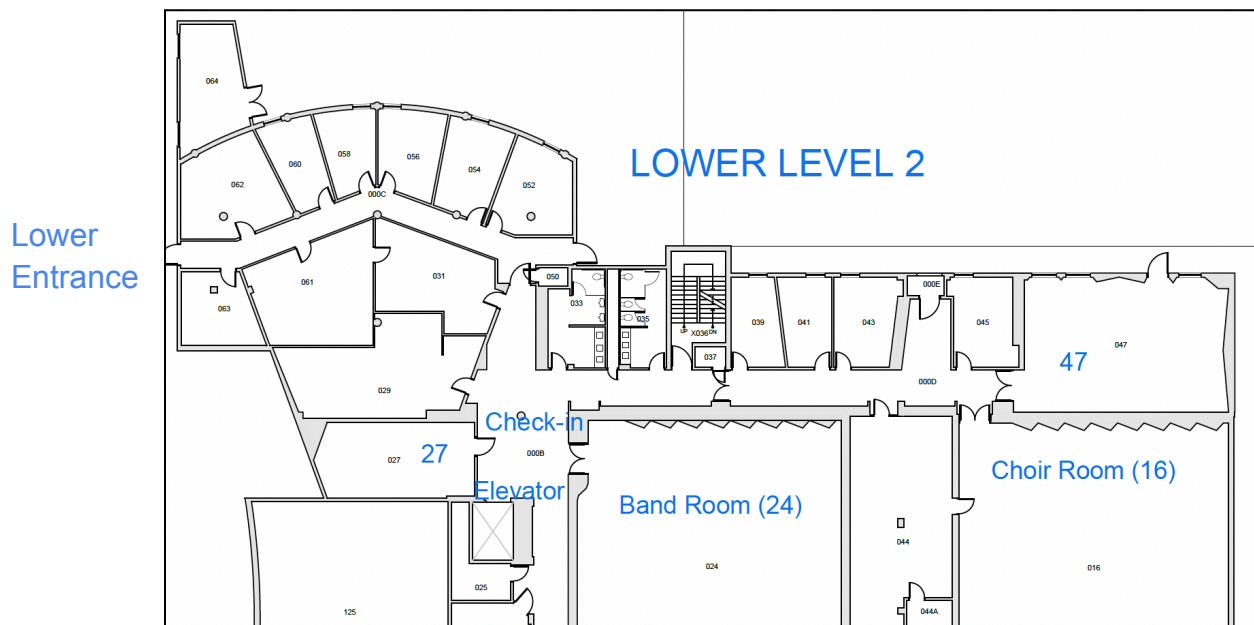

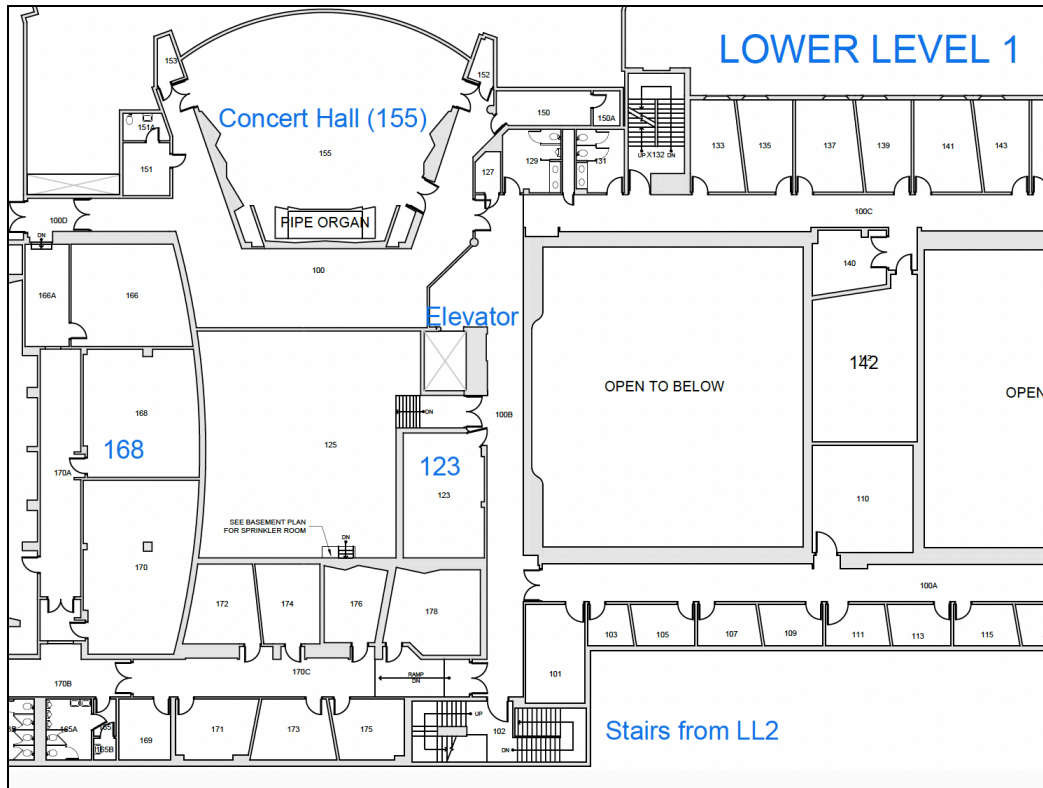

Drop-off & Pick-up

Student drop-off and pick-up is in Lot 11G, on the southwest side of the Performing Arts Center. Volunteers and traffic cones will be there to guide students to the indoor, upper entrance or the outdoor, lower entrance (through Lot 25G). For the first few weeks of each session, there will be signs directing students to the check-in area on Lower Level 2. The upper entrance is a tricky route, but again, students learn it quickly!

At the end of rehearsal, students will be reminded to walk up to Lot 11G, unless their parents are in the lower lobby or elsewhere to meet them. Please **DO NOT** drive into Lot 25G for pick-up, as this creates a safety hazard for anyone walking up the ramp.

Parking

Lot 11G and Lot 6V (indicated by green arrows on the map, next page) may be used for visitor parking. However, parking in Lot 25G (below Lot 11G) is not allowed. These parking spaces are reserved for WWU faculty and staff at all hours, and the Western Parking Office has been known to ticket people who park without permits.

- The Performing Arts Center is indicated with a **red rectangle** on the map.
- Parking is available (for a fee) in Lot 11G and Lot 6V, indicated by **green arrows**.
- **DO NOT** drive into Lot 25G for drop-off or pick-up. Parking is not allowed in Lot 25G.

Concerts

Day, Time, and Location

Free concerts are held once per session on Monday evenings in December, March, and June. The Philharmonia and Symphony have the pleasure of performing at the Concert Hall in the Performing Arts Center (PAC) at WWU. The Concert Hall can be accessed via the main entrance to the PAC on the main level. Concerts typically start at 7:30 PM with a musician call time of 5:30 PM. Be sure to check your email as each concert approaches for any revisions to the schedule or additional information.

Donations

Our concerts are free and open to the public. However, NSYS greatly appreciates donations of any amount. A violin case at the entrance to the Concert Hall will be available for cash and checks. A QR code will also be posted for those who wish to make a donation via PayPal.

Parking

NSYS reserves parking for individuals with limited mobility in Lot 11G. If you are able-bodied, please save this parking for guests who may need to park close to the venue.

Low-cost parking is available in Lot 6V, and free parking may be found along N. Garden St. (near Lot 6V) and along Highland Dr.

Reception

A reception immediately follows each NSYS outside the Concert Hall in the lobby of the PAC. We invite all families to bring a treat to share to celebrate the musicians' accomplishments. If possible, send a treat with your musician when they arrive for their call time so that volunteers can prepare the reception table before the concert.

Zoom and Recordings

NSYS makes every effort to provide a live link to each concert for friends and family who cannot attend in person. Watch your email as the concert approaches for a concert Zoom link. Please reach out to us at info@northsoundyouthsymphony.org with any questions.

Follow the NSYS YouTube Channel (<https://www.youtube.com/@NorthSoundYouthSymphony>) to view recordings of previous concert pieces and to enjoy new recordings as they are released.

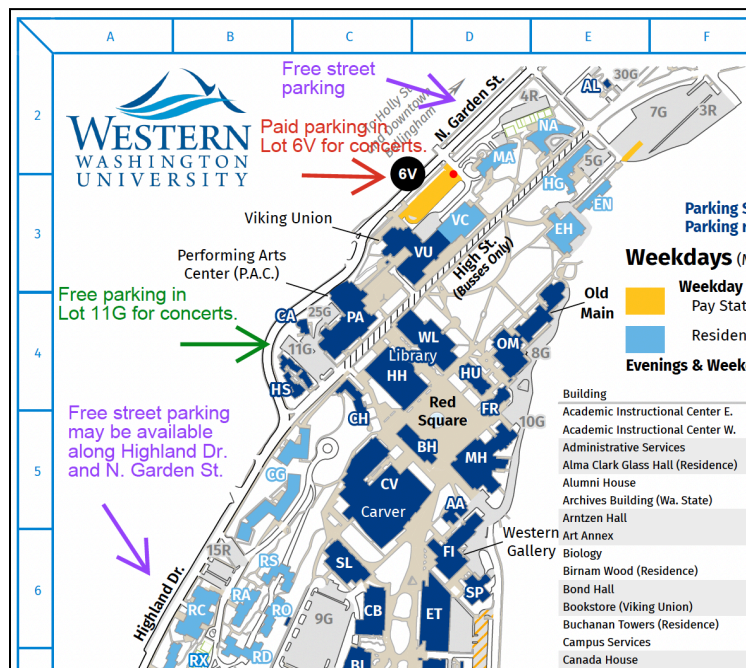

Support NSYS

Tuition

NSYS tuition for the season is \$450, or \$150 per session (fall, winter, and spring). Payments may be made by check or through PayPal in three installments. If paid in full at the beginning of the season, there is a \$30 discount. Siblings also receive a \$30 discount, or \$10 per session.

NSYS is committed to welcoming all musicians regardless of their ability to pay tuition. Scholarship assistance is available. Please email president@northsoundyouthsymphony.org for more information.

Volunteers

The success of North Sound Youth Symphony depends on its volunteers! At the beginning of each session, parents and guardians will receive an email invitation to a SignUp Genius. We request that each family commits to at least two volunteer opportunities which include providing snack, supervising a rehearsal, or providing concert support.

Snack Provider: If you sign up as one of two volunteers providing snacks for a rehearsal, please send enough snacks for approximately 40 musicians. Options include, but are not limited to, juice, vegetables, fruits, cookies, and crackers. Some musicians are vegan and/or gluten-free. If you are able to provide something that meets these dietary restrictions, please label it accordingly. If you send perishable items, please be sure that you or your child comes by the check-in area at the end of rehearsal to take any leftovers home.

Rehearsal Supervisor: These critical volunteers support students with checking in, finding room assignments, and serving and cleaning up from snack. A full description of the responsibilities can be found [here](#). There is often a fair amount of down time, so bring a book or something to do!

Concert Support: Opportunities for supporting our concerts include hanging up flyers around town, setting up for the reception, serving at the reception, and cleaning up. We appreciate all the people who help to make each concert a success!

We know that the NSYS families' busy lives may make volunteering difficult! If you find that volunteering for a particular session will be too challenging, we invite you to make a monetary donation to cover snacks and other supplies. Thank you in advance for your support!

Sponsorships, Fundraising, and Donations

Tuition only partially funds NSYS's operating expenses, so we rely on fundraising, donations, and sponsorships. Please consider supporting us—or inviting family and friends to support us—in any or all of the following ways:

Sponsorships: NSYS welcomes different levels of local business sponsorship. Visit our sponsorship page for more information about these levels: <https://www.northsoundyouthsymphony.org/sponsor-information/>. If you have connections to a local business that you would like us to reach out to, please email info@northsoundyouthsymphony.org with contact information.

Fundraising: Each session, NSYS aims to conduct at least two fundraising events. Menchie's and MOD Pizza are popular options. Watch for more information about these events. Every dollar counts! If you have other suggestions for fundraising, please reach out to info@northsoundyouthsymphony.org.

Donations: While we always accept donations, your grocery shopping at Fred Meyer is an additional—and so easy!—way to support NSYS without making a direct donation. Use the QR code at the right or [this link](#) to sign up for Fred Meyer's Community Rewards Program. A portion of the Fred Meyer profits goes directly to NSYS. The NSYS organization code is EI879.



Social Media

Please follow us on [Facebook](#) (NorthSoundYouthSymphony) or [Instagram](#) (northsoundyouthsymphony), and subscribe to our [YouTube channel](#). Sharing our posts is a great way to spread the word about NSYS and the wonderful opportunities it provides to our young musicians.

NSYS Code of Conduct

As a member of the North Sound Youth Symphony, I will:

- Be ready to play at 6:30! This includes:
 - Checking in
 - Setting up my chair and stand
 - Assembling and tuning my instrument
 - Having my folder, music, and a pencil ready to go
- Have my phone off and away
- Listen respectfully and follow instructions
- Mark my music as directed
- Ask questions when I need help or don't understand something
- Help clean up after rehearsals. This includes:
 - Putting away my chair and stand
 - Throwing away my trash
 - Doing anything else that I see needs to be done
- Practice between rehearsals
- Email NSYS and my conductor if I will miss or be late to rehearsal
- Be kind and encouraging to myself and others
- Have a positive attitude!

We are happy to have you as a member of North Sound Youth Symphony!

Complete the section below and turn it in at your next rehearsal. Thank you!

NSYS 2024–2025
Printed Name: _____

Circle One: Philharmonia / Symphony

Instrument: _____

Signed: _____ Date: _____